

## INSTALLATION INSTRUCTIONS

### Product name:

VILLA Round Down Light

### Model No. :

VRA050 VRA075 VRA095 VRA120

VRF050 VRF075 VRF095 VRF120



Please read these instructions carefully before commencing installation and retain for future reference. If any problem, please consult qualified electricians to get some help. These products must not be modified. If any modification is made it may invalidate the warranty and may render the product un-safe. All electrical installations must be carried out according to current IEE Wiring Regulations.

### IMPORTANT SAFETY NOTES

1. Make sure all main power are disconnected before commencing installation or lamp change and (if a fuse box is used) remove the appropriate circuit fuse to avoid accidental switching on of the mains supply.
2. Connect to a 220V-240V supply in accordance with IEE regulations.
3. Make sure all connections are tight with no loose strands.
4. Ensure fire regulations are not breached when fitting your lights.
5. If you are in any doubt regarding these instructions, consult a qualified electrician.

### WARNING:

1. For indoor use only
2. Please ensure that the packaging is disposed of in a safe environment.
3. If cable is defected, do not use or exchange the cable.
4. We do recommend that a qualified electrician should be used to install the products.
5. Do not look at the lighted lamp directly.

### ① INSTALLATION METHOD ONE (Applicable to cut out size of $\Phi 50\text{mm}$ , $\Phi 75\text{mm}$ )

<b>1</b> Open a hole in the ceiling, suitable for thickness of 2-30mm 	<b>2</b> Lightly press the plastic clasp on the both side of the lamp body, and use a screwdriver to separate the mounting ring, lamp body and secondary reflector. 	<b>3</b> Press the two clips with your hands to install the mounting ring into the ceiling hole. 	<b>4</b> Connect the power line to the mains, connect the live line to "L" and connect the neutral line to "N". 
<b>5</b> Put the driver into the ceiling. 	<b>6</b> Install the lamp body into the mounting ring, make sure the plastic clasp be clipped into the mounting ring and confirm it's well installed. 	<b>7</b> Align the locating post of reflector with the locating slot and put it into the lamp body, confirm it's well installed. 	<b>8</b> Installation complete, power on test. 

### ② INSTALLATION METHOD TWO (Applicable to cut out size of $\Phi 50\text{mm}$ , $\Phi 75\text{mm}$ )

<b>1</b> Open a hole in the ceiling, suitable for thickness of 2-30mm 	<b>2</b> Connect the power line to the mains, connect the live line to "L" and connect the neutral line to "N". 	<b>3</b> Press the two clips with your hands to install the mounting ring into the ceiling hole. 	<b>4</b> Installation complete. 
---------------------------------------------------------------------------	---------------------------------------------------------------------------------------------------------------------	------------------------------------------------------------------------------------------------------	-------------------------------------



## INSTALLATION INSTRUCTIONS

**③ INSTALLATION METHOD THREE** (Applicable to cut out size of  $\Phi 95\text{mm}$ ,  $\Phi 120\text{mm}$ )

- 1** Open a hole in the ceiling, suitable for thickness of 2-30mm

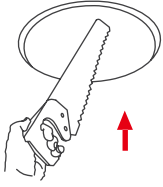

- 2** Lightly press the plastic clasp on the both side of the lamp body, and use a screwdriver to separate the mounting ring, lamp body and secondary reflector.

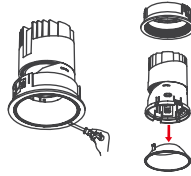

- 3** Press the support feet on both sides of the mounting ring with two hands to install the mounting ring into the opened ceiling hole.



- 4** Turn the support foot screw to make the support foot open as shown in the figure, and continue to turn the screw until it is confirmed that the support foot is fixed on the ceiling.

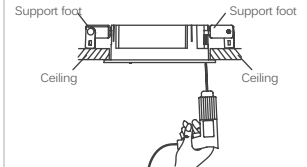

- 5** Connect the power line to the mains, connect the live line to "L" and connect the neutral line to "N".

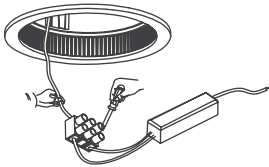

- 6** Put the driver into the ceiling.

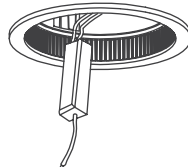

- 7** Install the lamp body into the mounting ring, make sure the plastic clasp be clipped into the mounting ring and confirm it's well installed.

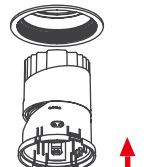

- 8** Align the locating post of reflector with the locating slot and put it into the lamp body, confirm it's well installed.

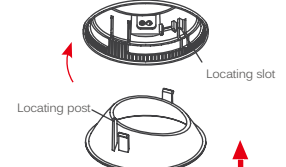

- 9** Installation complete, power on test.

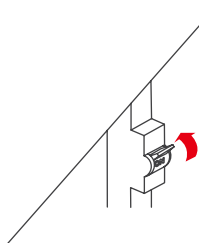
**④ INSTALLATION METHOD FORE** (Applicable to cut out size of  $\Phi 95\text{mm}$ ,  $\Phi 120\text{mm}$ )

- 1** Open a hole in the ceiling, suitable for thickness of 2-30mm

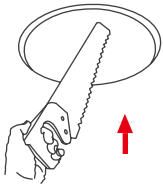

- 2** Connect the power line to the mains, connect the live line to "L" and connect the neutral line to "N".

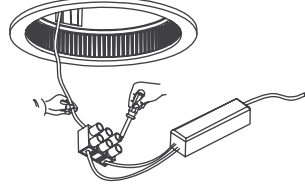

- 3** Pull up the clips on both sides, and install the lamp into the ceiling hole.

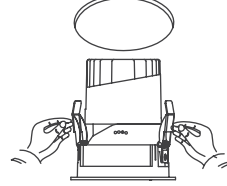

- 4** Confirm that the lamp body is installed into the opened ceiling hole, and the clips on both sides are in the state of diagram, confirm that the installation is firm, installation complete.

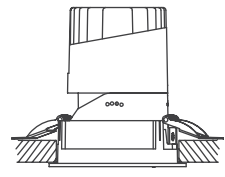
**⑤ INSTALLATION METHOD FIVE** (Applicable to cut out size of  $\Phi 95\text{mm}$ ,  $\Phi 120\text{mm}$ )

- 1** Open a hole in the ceiling, suitable for thickness of 2-30mm

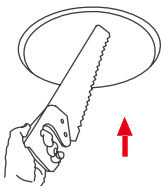

- 2** Connect the power line to the mains, connect the live line to "L" and connect the neutral line to "N".

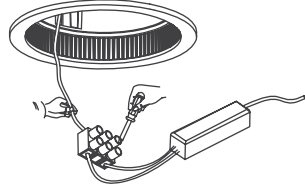

- 3** Press the clips on both sides of the mounting ring with two hands to install the surface ring into the opened ceiling hole.

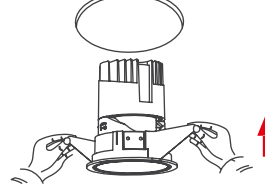

- 4** Confirm that the lamp body is installed into the opened ceiling hole, and the elastic clips on both sides are in the state of diagram, confirm that the installation is firm, installation complete.

